

1220/189

1220/193

1220/192

MATERIAL: 12.2.
BOD: J.A. 1.

k.ú. Pavlovice u Přerova



U vjezd

ka.ú. Vilyřovice

Areal cecmištrouder-
SSok

(Pod Holubím vrchem)

šprískoška
1MM²

MATERIÁL: 12.2.
BOD: d.d.

Šumpark ← SILVICE
18872 ← RAPORTN

Šumpark ←

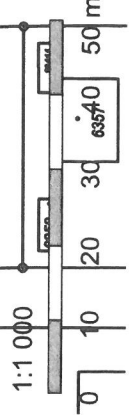

k. u. výcv

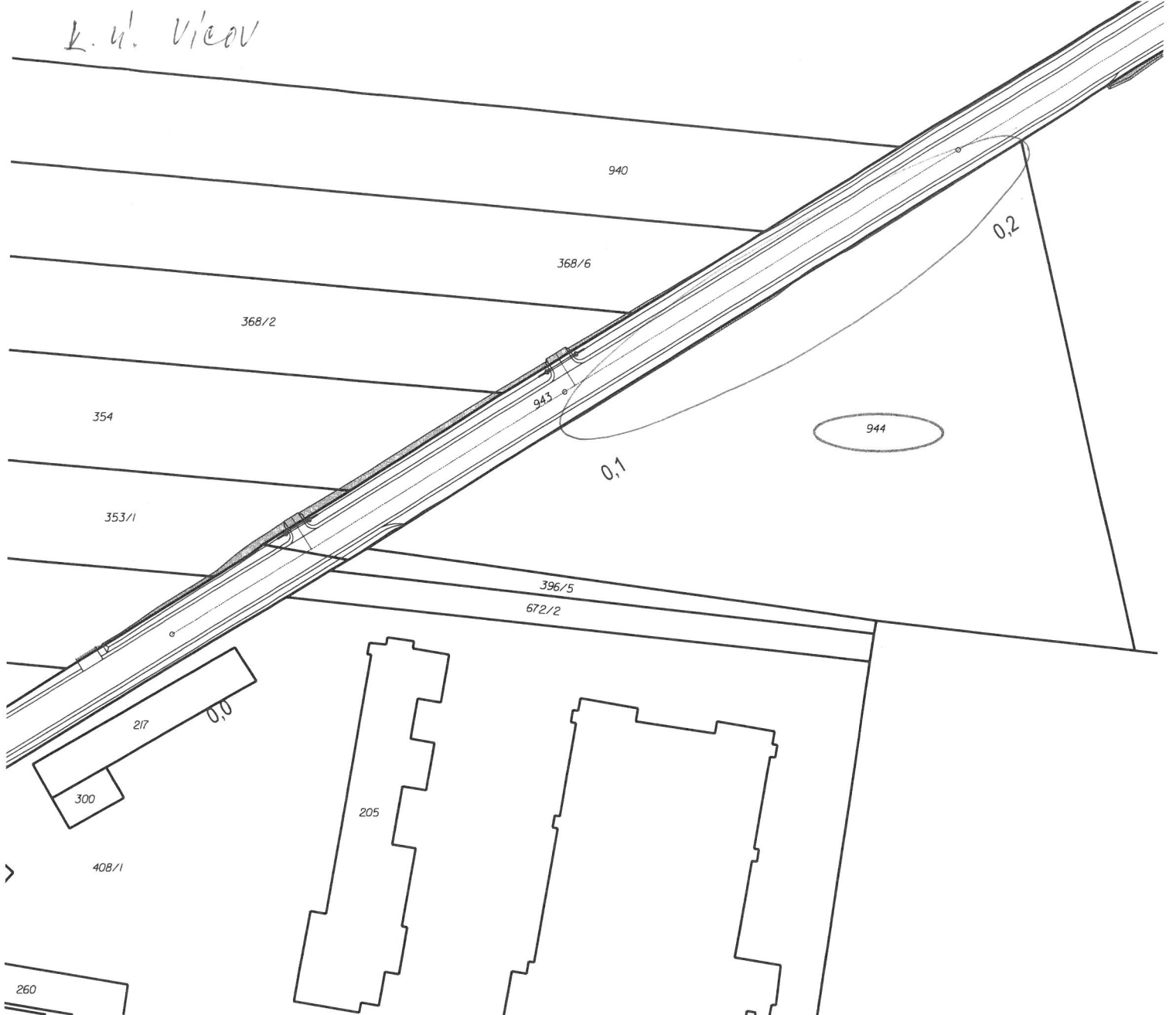

LEGENDA:



TRVALÝ ZÁBOR

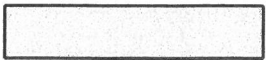

DOČASNÝ ZÁBOR DO 1 ROKU



DOČASNÝ ZÁBOR NAD 1 ROK



VĚCNÉ BŘEMENO



KATASTRÁLNÍ HRANICE



MATERIÁL: 12.2.
BOD: 2.3.

k.ú. Henčlov

MATERIÁL: *MSL*
BOD: *2.4.2.5/2.7.*
28.-2.12.

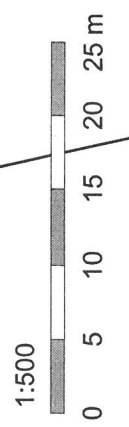
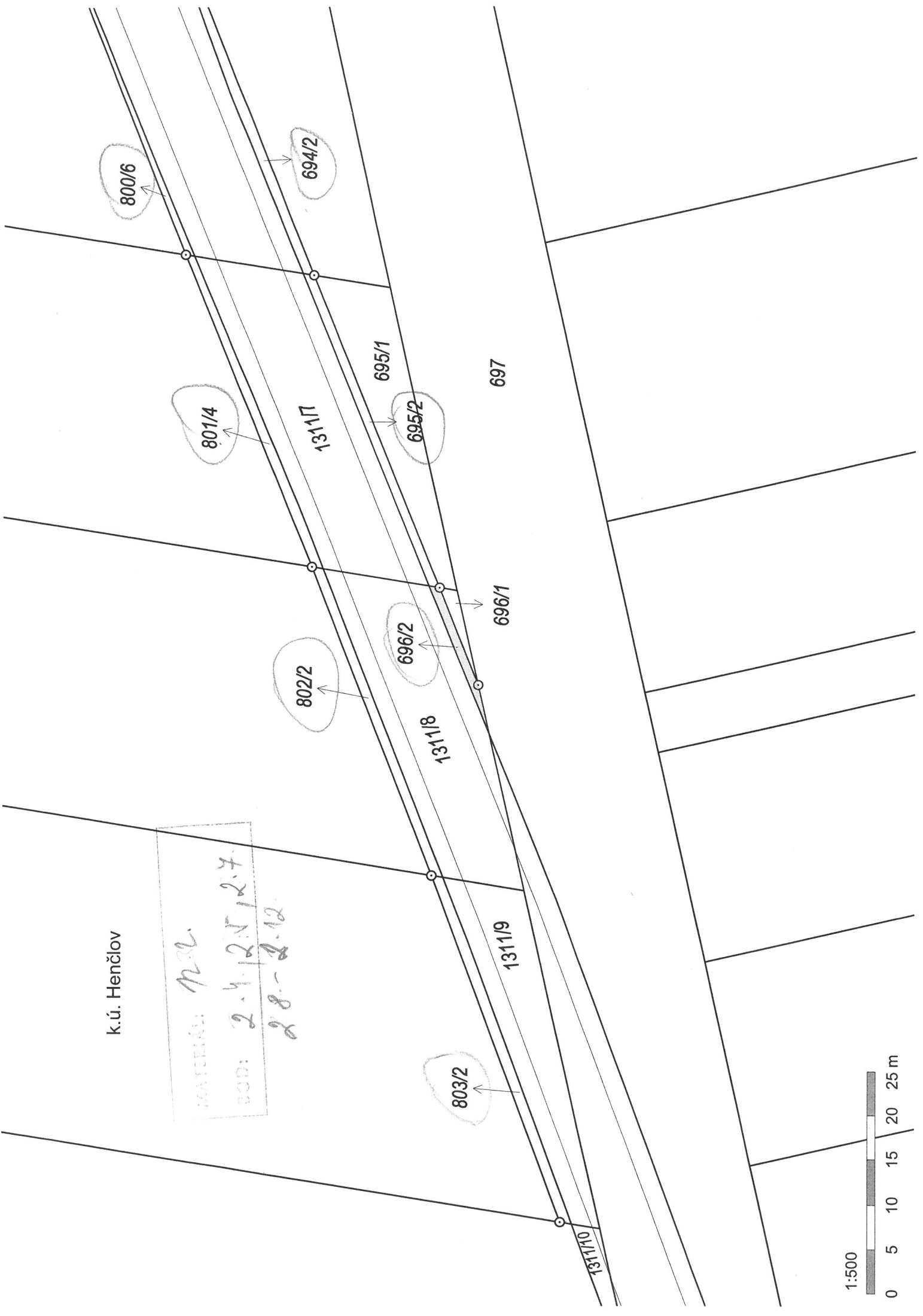

k.ú. Henčlov

MATERIÁL: 12.2.
BOD: 2.6.12.13.2.14

808

1311/11

1311/12

710/2

711/2

1311/13

1311/14

1311/15

1311/16

714/2

1311/17

1:500

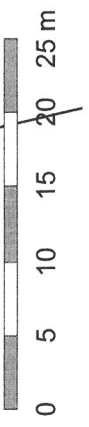

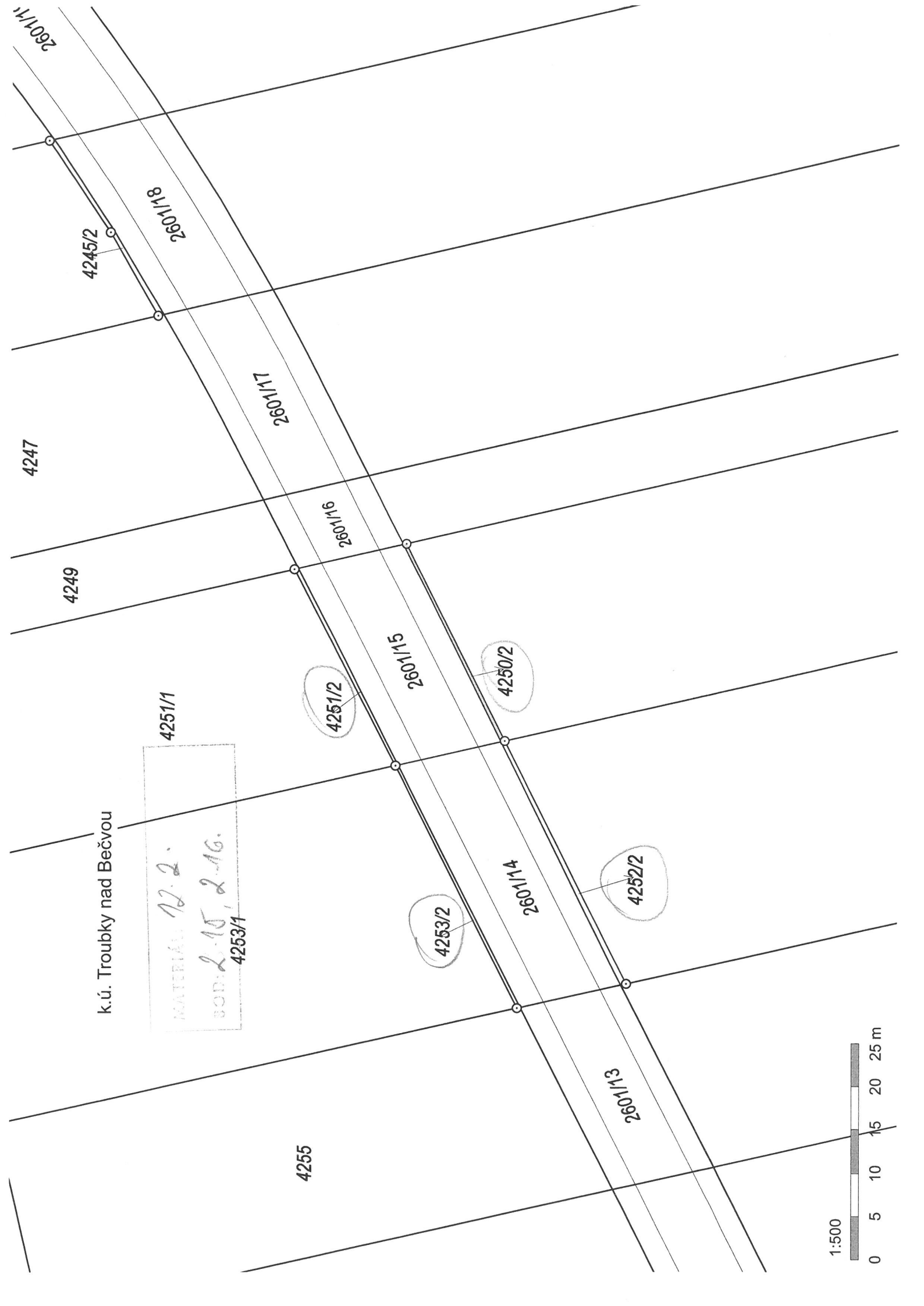

2601/14

4245/2

2601/18

4247

4249

2601/17

2601/16

2601/15

4251/2

4250/2

4251/1

k.ú. Troubky nad Bečvou

MATERIÁL 12.2.

SOB: 2.15, 2.16.

4253/1

4253/2

2601/14A

4252/2

4255

2601/13

1:500

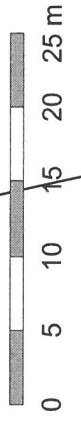

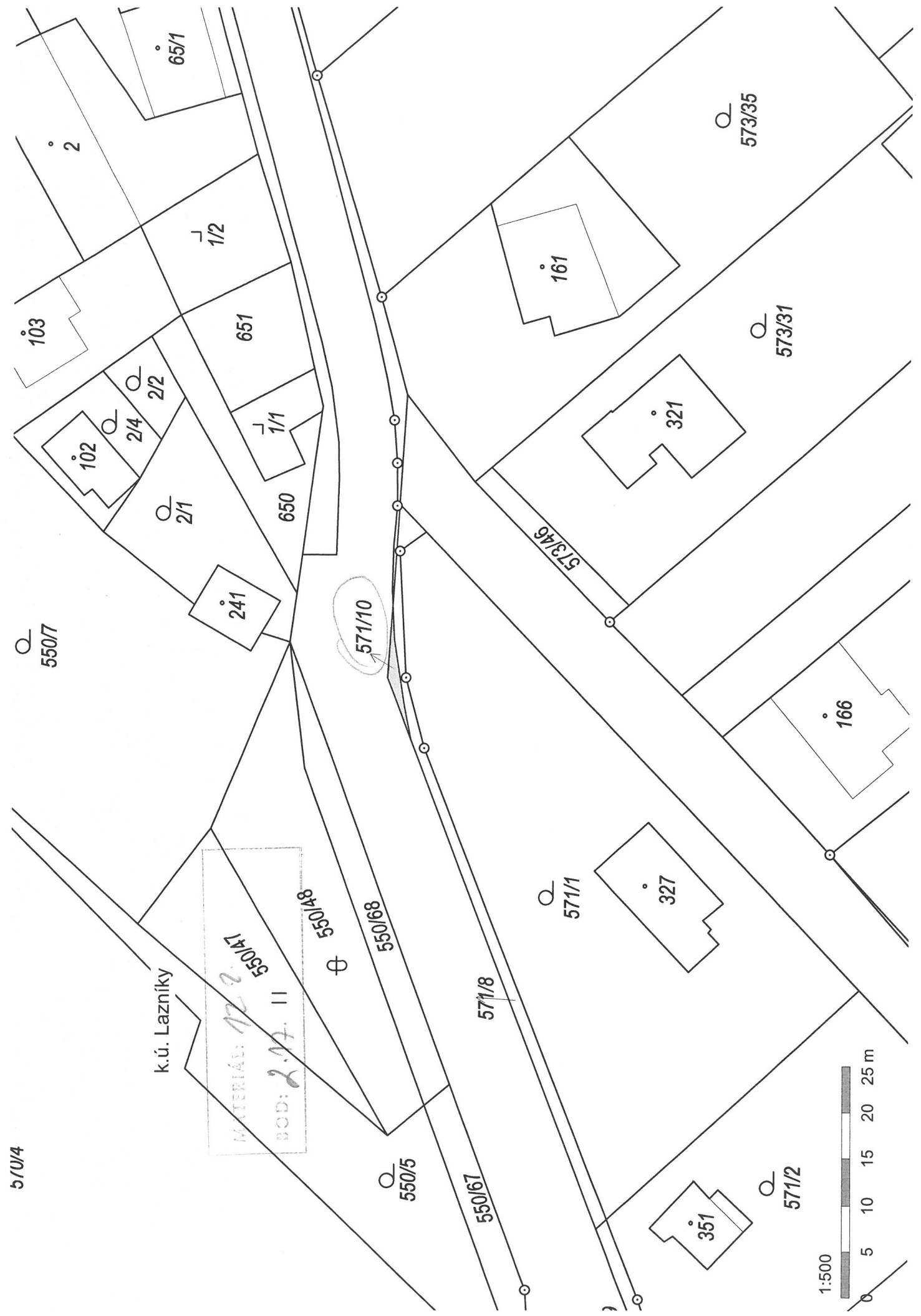

k.ú. Lazníky

MATERIÁL: 122
 BOD: 2.17. II
 550/47
 550/48

571/10

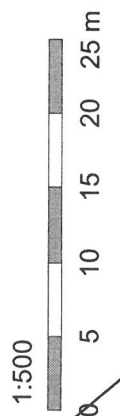

k.ú. Lazníky

MATERIÁL: 12 l.
BOD: 2.18, 2.19.

568/7

568/6

568/5

569/3

569/2

570/10

594/1

1:500

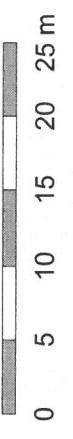

0 5 10 15 20 25 m

k.ú. Tršice

MAPEKÁK: 12.2.
BOD: 2.20.

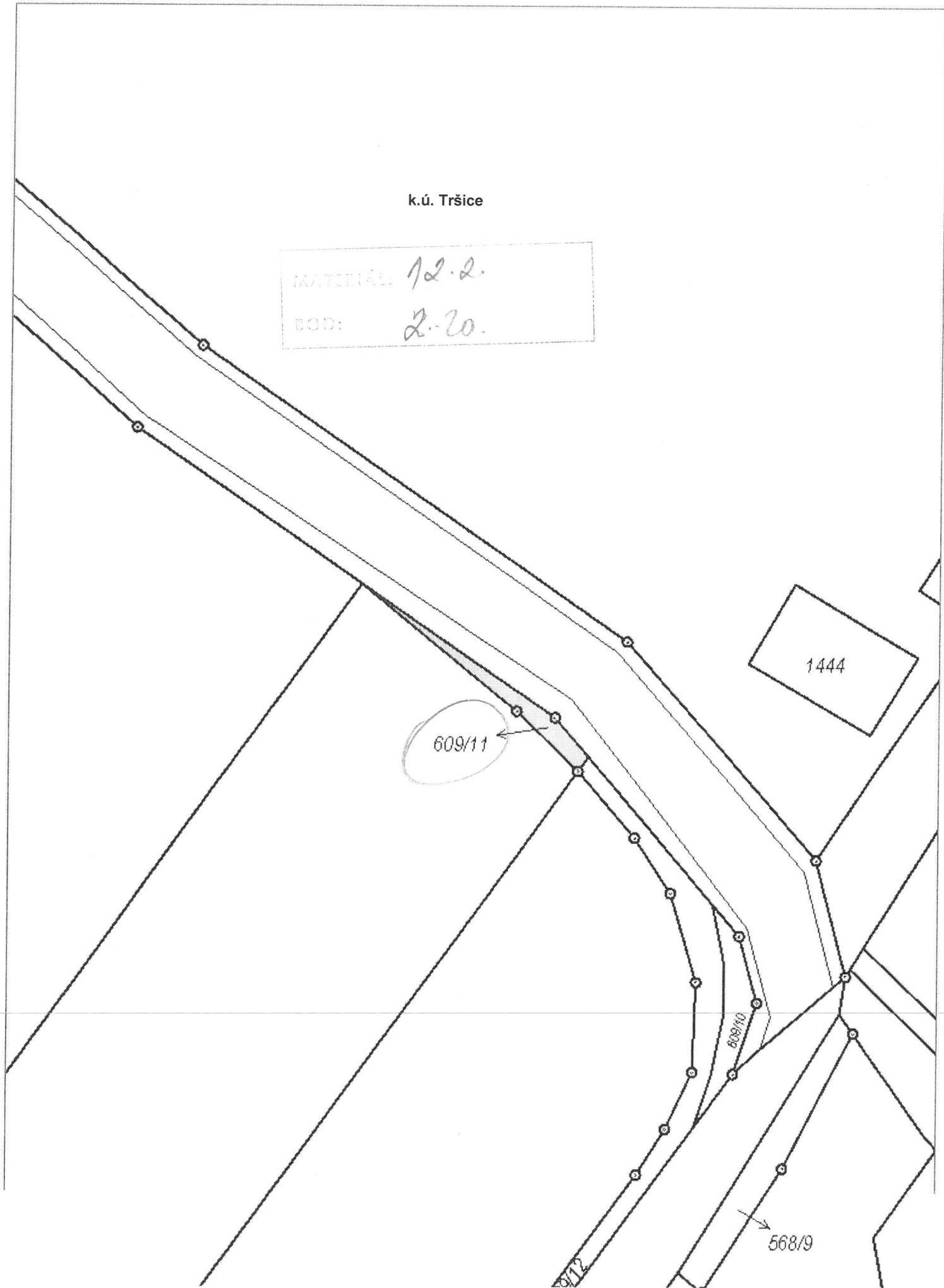



k.ú. Hvozíce

MATERIÁL: 12.2.
DOB: 2.22.

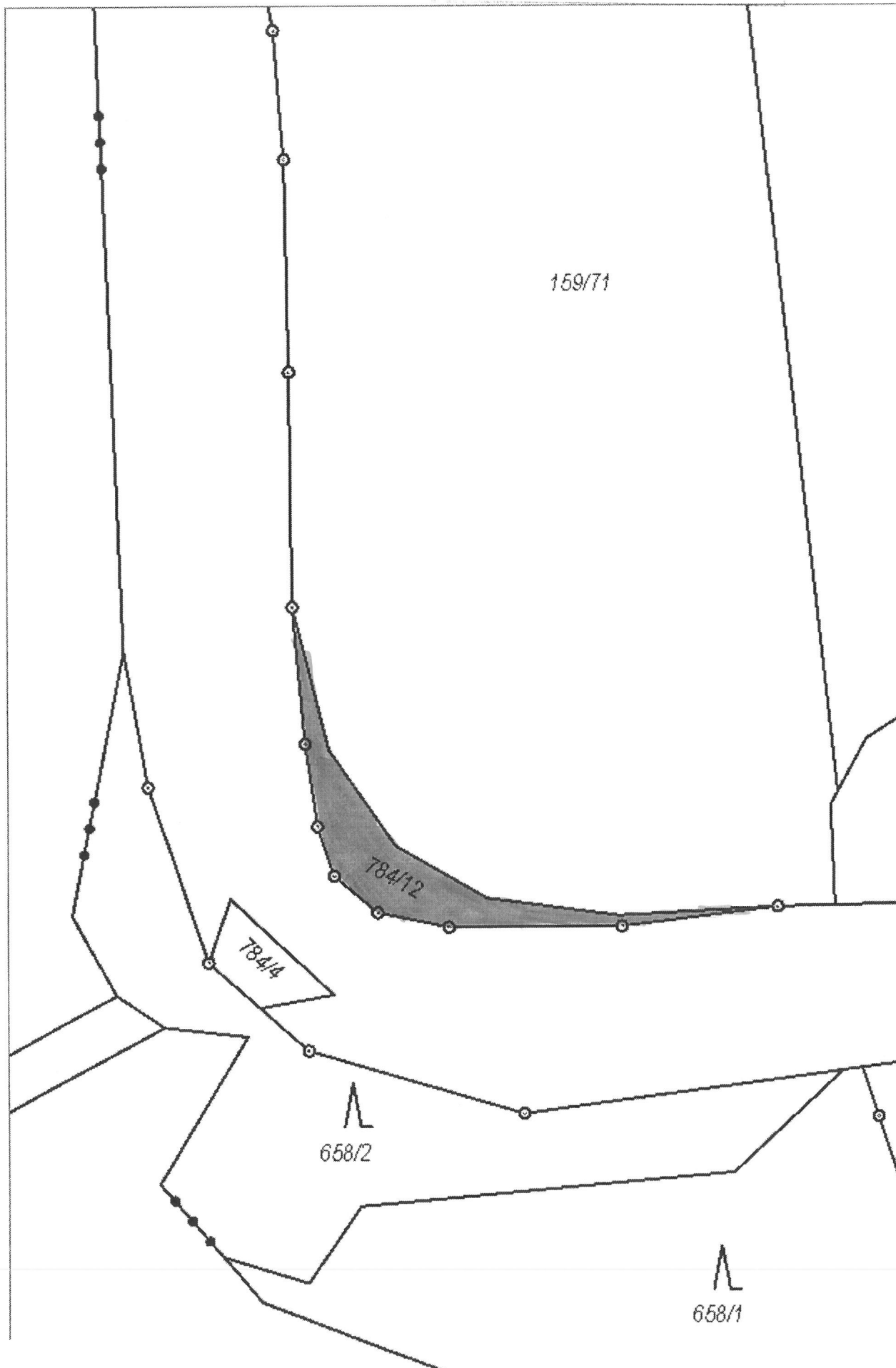

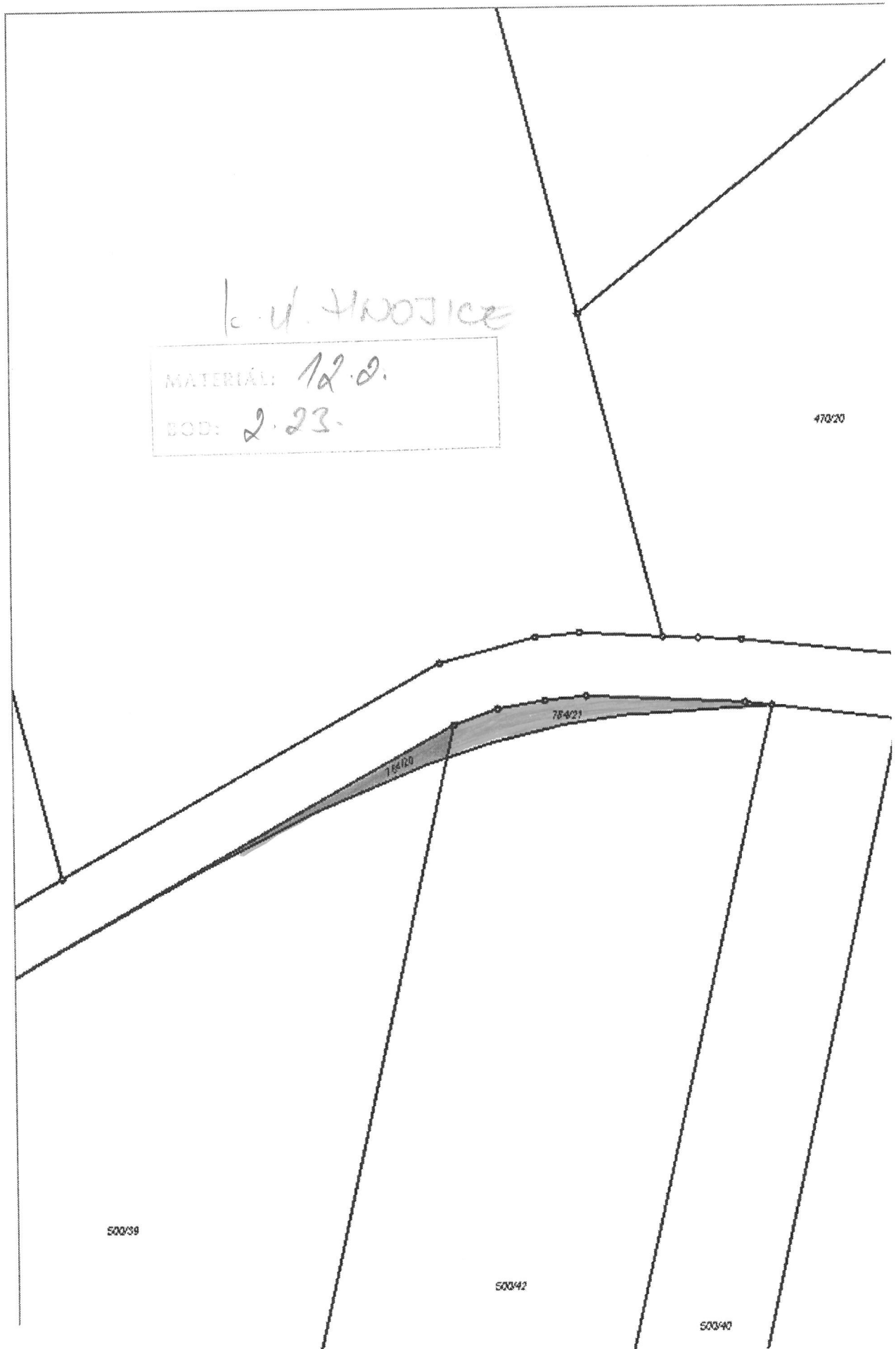

k.ú. Lázice u Šternberka

MATERIÁL: 12.2.
EOD: 2.24-2.30.

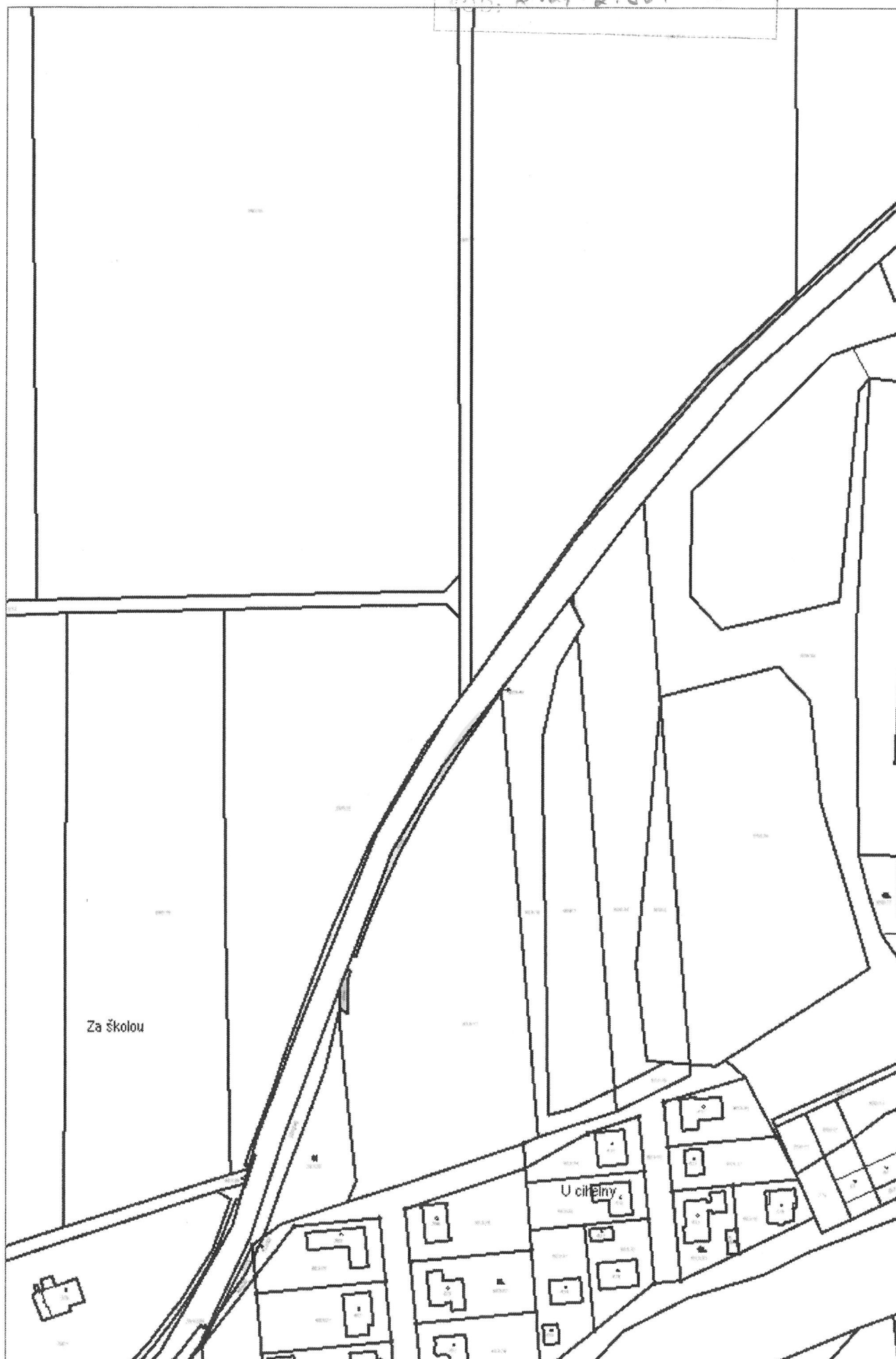



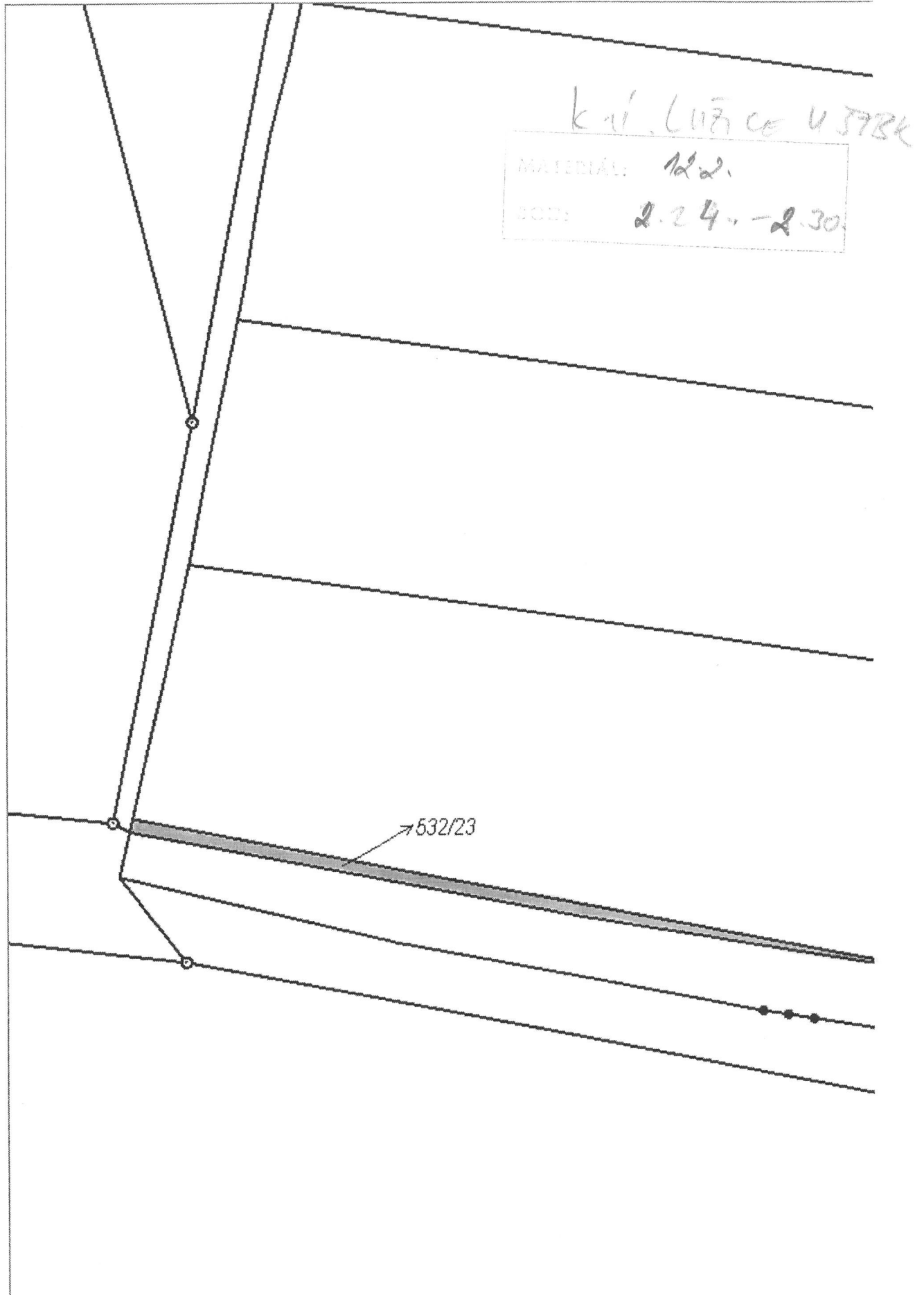

k.ú. Velká Bystřice

MATERIÁL: 12.2.
BOD: 2.31.

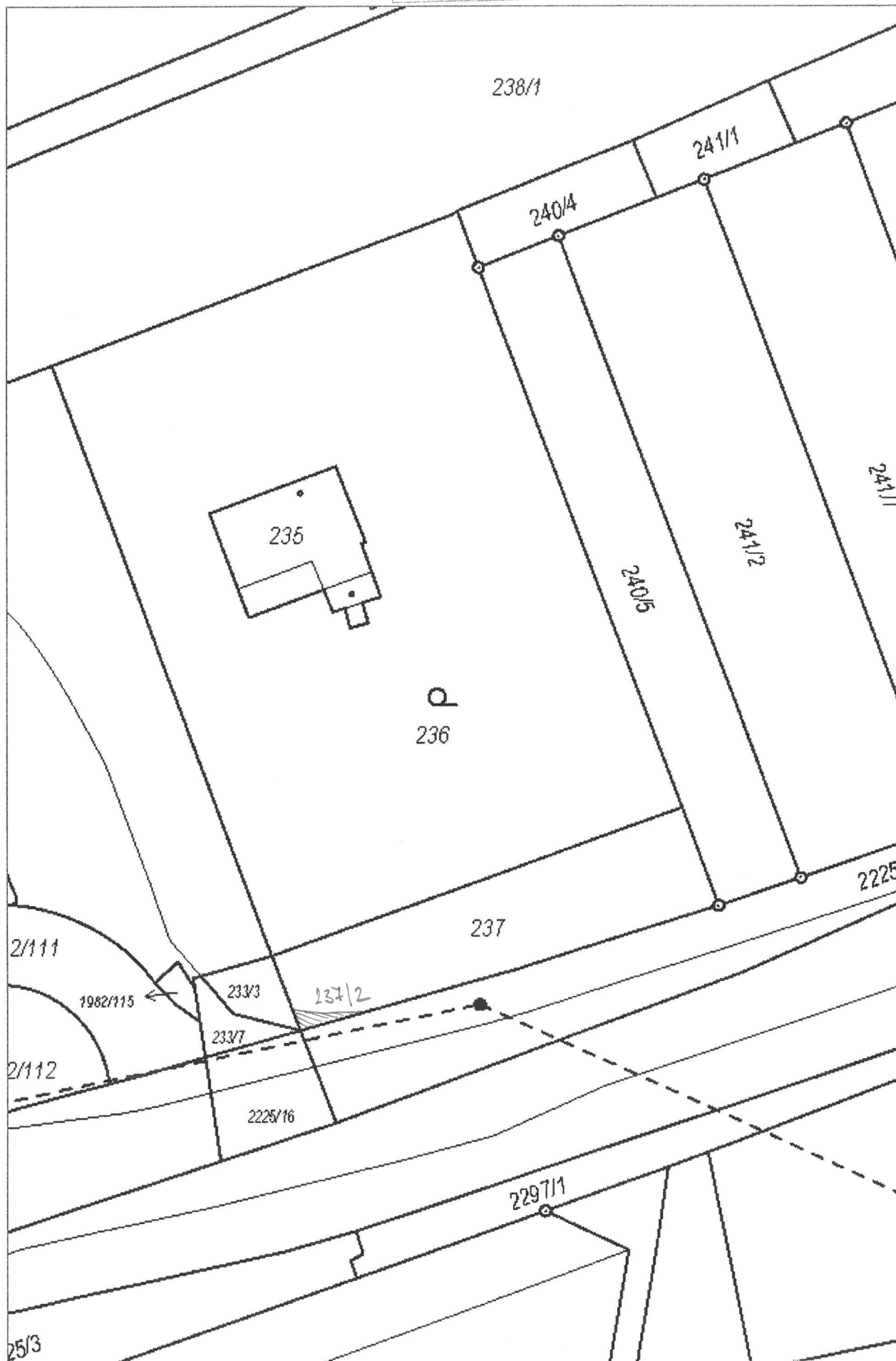

k.u. Liboš

MATERIÁL: 22.2.
BOD: 3.1.-3.3.3.

