

K.Ú VALSOVICE

MATERIÁL: 13.6.
BOD: 2.1.



258/1

180

181

1321

862/1

Λ
862/2

1257/2

264

259/1

832/27

832/12

ρ
832/7

Λ
1257/5

II
862/8

240
→ 182

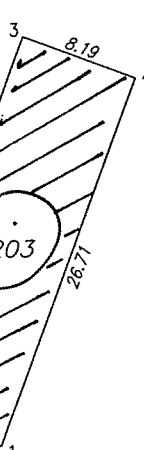

114

ρ
832/6

1248

8

181

ρ
832/15

947/2

948

949

kū Hejolu

MATERIÁL: 13.6.

BOD: d.d.

